



Welcome to **KATANNING CENTENNIAL** **ALL SCHOOLS REUNION**

September 9 and 10, 1989

PART OF KATANNING'S CENTENARY CELEBRATIONS 1889-1989



*Katanning's First Permanent School Building
Situated at the corner of Amable and Taylor Streets it is now a Museum.*

Official Programme

Saturday, September 9, 1989

1 PM - AUSTRAL TERRACE (AT PIESSE STATUE)

Welcome to Katanning

By Katanning Shire President, Geoffrey Beek J.P.

Unveiling of plaque at Katanning's first school site.

Dr Warren Loudon, Chief Executive Officer at the W.A. Ministry of Education.

Vote of Thanks

Ainslie Evans, Reunion Committee Chairman.



KATANNING CENTENNIAL ALL SCHOOLS REUNION

Saturday's Programme (continued)

1.30 PM KATANNING PRIMARY SCHOOL

Registration and Information area - Bokarup Street.
School open for inspection. Book donations at the Library.

2.30 PM EX-STUDENTS AND EX-TEACHERS MEET IN DESIGNATED ROOMS AS PER BACK OF THIS PROGRAMME

Afternoon Tea served from School Canteen. Mini Fair and Sale of Souvenirs during the day.
School closes at 5 pm.

4 PM BUS TOUR OF TOWN FROM REGISTRATION AREA

BUFFET DINNER

7 pm for 7.30 pm start at Saint Andrew's Residential College.
Bar facilities provided by the Rotary Club of Katanning.
M.C. Colin Stade.

SPEAKERS: Deldre Weston, Dick Old, Kath Levitski and Ainslie Evans.
Complimentary bus service from Mill corner at 6.45 and 7 pm. Return trip following the dinner.

OLD TIME DANCE

8 pm-2 am at the Katanning Town Hall. Organised by the Woodanilling Dance Committee.
Band "Wallace of Wagin".
Supper provided by Miss Australia Guest Committee. Bar facilities provided by Lions Club of Katanning.

RURAL YOUTH CABARET

8 pm till 1 am at the Ram Pavilion, Katanning Show Grounds. Organised by the Katanning Rural Youth Club.
Band "Jackknife" (local ex-students).

NOTE: Several year groups are meeting for their dinner at other venues.

Sunday, September 10, 1989

SAINT PATRICKS CHURCH

9.30 am Mass (Reunion Mass). 10.30 am Morning Tea. School open for inspection.
11 am-12 noon Reidy House (St Rita's Convent) open for inspection.

KOBEELYA

9.30 am Chapel Service in Kobeelya Chapel. To be taken by the Bishop of Bunbury the
Right Reverend Hamish Jamieson. Followed by Morning Tea.

BRAESIDE PRIMARY SCHOOL

10 am-12 noon Open for inspection. Book donations at Library. Light Morning Tea.

WOODANILLING

9 am Church Service. 10 am Morning Tea and School Inspection. Light Lunch in Hall.

KATANNING

BUS TOURS

10.30 am - Old School Sites Tour (from Mill corner) 10.30 am and 11.30 am Town Tours (from Mill corner).

ALL AGES PLAYGROUND

Katanning's unique attraction. MINI-TRAIN running from 10.30 am.

SAINT ANDREW'S RESIDENTIAL COLLEGE

11 am-2 pm 25th Anniversary Luncheon for ex-boarders.
Contact College or registration tent for numbers attending.

MONSTER BARBECUE AND PICNIC LUNCH

12 noon-2 pm at Katanning Senior High School. Variety of Lunches available for purchase.
1 pm-3 pm High School open for inspection. Book donations accepted at Library.

FAREWELL

3 pm Katanning High School. Farewell from Katanning All Schools Reunion Committee.



KATANNING CENTENNIAL ALL SCHOOLS REUNION

General Information

ARCHIVES (Ex-Students & Ex-Teachers Association)

An archives committee will be set up following the All Schools Reunion to take steps to establish a permanent school archives in the Mill Museum. Profits from this weekend will be channelled into a schools archives account.

Those interested in joining the committee, donating cash or items of memorabilia, or helping in any way please contact Ainslie Evans or Wendy Kirkby any time.

Supporting committees will donate portion of their weekend profits to the schools archives project.

PHOTOGRAPHERS

Official photographers will be at most events. Make your own contact regarding their copies.

MILL MUSEUM - SCHOOL ARCHIVES

The Mill Museum is situated on the corner of Clive Street and Austral Terrace and will be open from 10 am to 8 pm on Saturday and 10 am to 4 pm Sunday.

Ground Floor - No admittance charge. Sales of Katanning Centenary Souvenirs (shirts, spoons, etc), books by local authors.

First Floor - Admission \$1. Schools historic display. Orders can be taken for reprints of photographs and photocopies of any display articles.

Display will remain in the mill for approx 3 weeks following reunion weekend.

Kobeelya Archives are also on this floor.

HISTORICAL SOCIETY MUSEUM

Taylor and Amable Streets. This was Katanning's first school building. Open 10 am to 1 pm Saturday and 10 am to 4 pm Sunday.

STAMPS

A pre-stamped special edition centenary envelope is available for purchase at the Katanning Primary School registration area during the afternoon. Also available from the Mill Museum or the Katanning Post Office for the following two weeks. This is a limited offer and a COLLECTORS MUST!

OLDEST TEACHER - OLDEST STUDENT

We would like to acknowledge the oldest returning teacher and the oldest returning student. Also the visitor to the reunion that travelled the longest distance.

Please place your name on the board in the reception area if you think you may qualify.

ALCOHOL

Department of Education regulations prevent the consumption of alcohol on school premises. Please respect school, equipment at all times.

CENTENNIAL TIME CAPSULE

The Apex Club of Katanning (Inc.) in conjunction with the Great Southern Herald and the Shire of Katanning is arranging the laying of a capsule in late December, 1989, to commemorate Katanning's 100 years.

Registration envelopes and "acid free" papers will be available from our manned booths at primary and high schools. They will also be available from the Mill Museum.

Enquiries to Lindsay Roy C/- P.O. Box 184, Katanning 6317.

SILVER CHAIN FLOWER DAY

This is an annual event on the Katanning Calendar and is usually held on the third Friday in September each year.

The break in tradition to the second weekend in September is to ensure the town is looking its best for this most important weekend. Katanning Silver Chain started in 1919 and has held flower days for many years.

ALL SCHOOLS REUNION ORGANISING COMMITTEE

Chairperson - Ainslie Evans. Secretary/Treasurer - Wendy Kirkby. Committee - Helen Kowald, Isobel Bradbury, Andrew Pritchard, Dawn Reynolds, Nancy Wake, Colin Stade, Alan Bell, Gerry Watson and Pat McCrechan.



KATANNING CENTENNIAL ALL SCHOOLS REUNION

Katanning Primary School

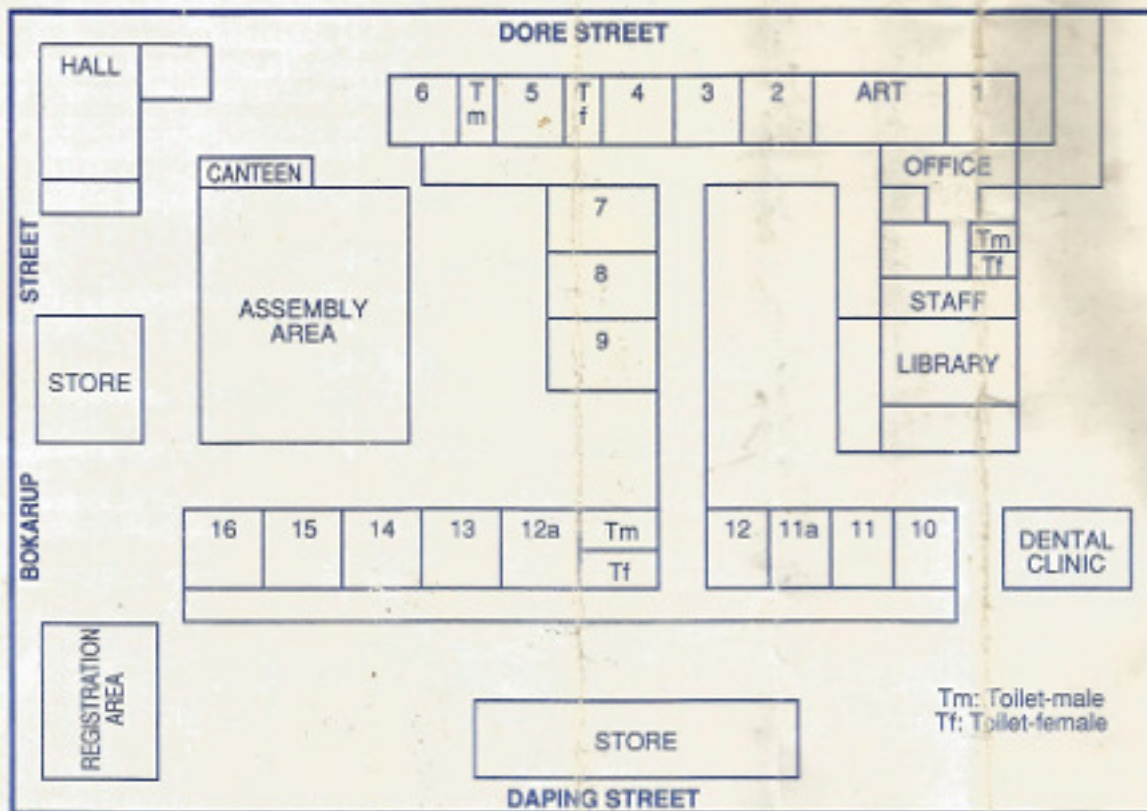

KEY

ROOM	FINAL YEAR CLASS (Std 9 - Junior Yr - Year 10)	PRESENT AGE
1	KSS 1935 or before	69 and over
2	1936-1940	64-68 years
3	1941-1945	59-63 years
4	1946-1950	54-58 years
5	HJHS 1951-1955	49-53 years
6	1956-1960	44-48 years
7	KSHS 1961-1965	39-43 years
8	1966-1970	34-38 years
9	1971-1975	29-33 years
10	1976-1980	24-28 years
11	1981-1989	Up to 23 years
12	Woodanilling	
13	Badgebup, Rockwell, Kwobrup, Coblinine	
14	Datatine, Corackine, Mean Mahn, Cartmeticup	
15	Moojebing, Glencoe, Marracoonda, Carrolup	
16	Ewlyamartup, Woodlyn (Murdong)	
LIB		
HALL	St Patrick's - all years	
STAFF	Kobeelya - all years	